

8/17/99

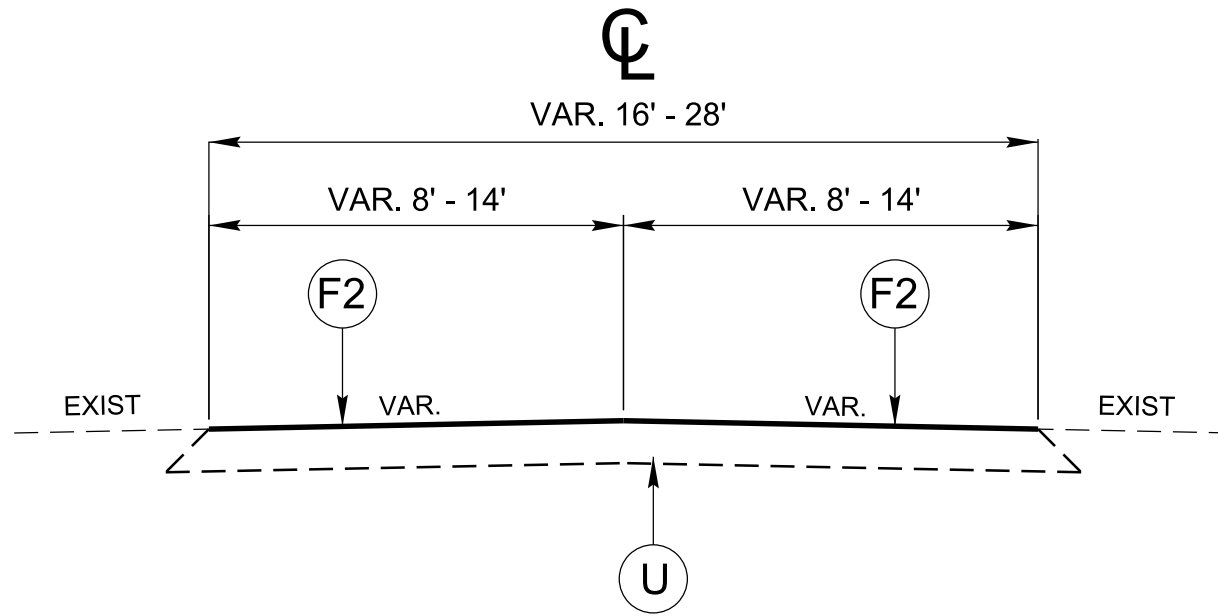

TYPICAL SECTION NO. 1
MAPS # 1-16, 18-21, 29-34, 40, & 44

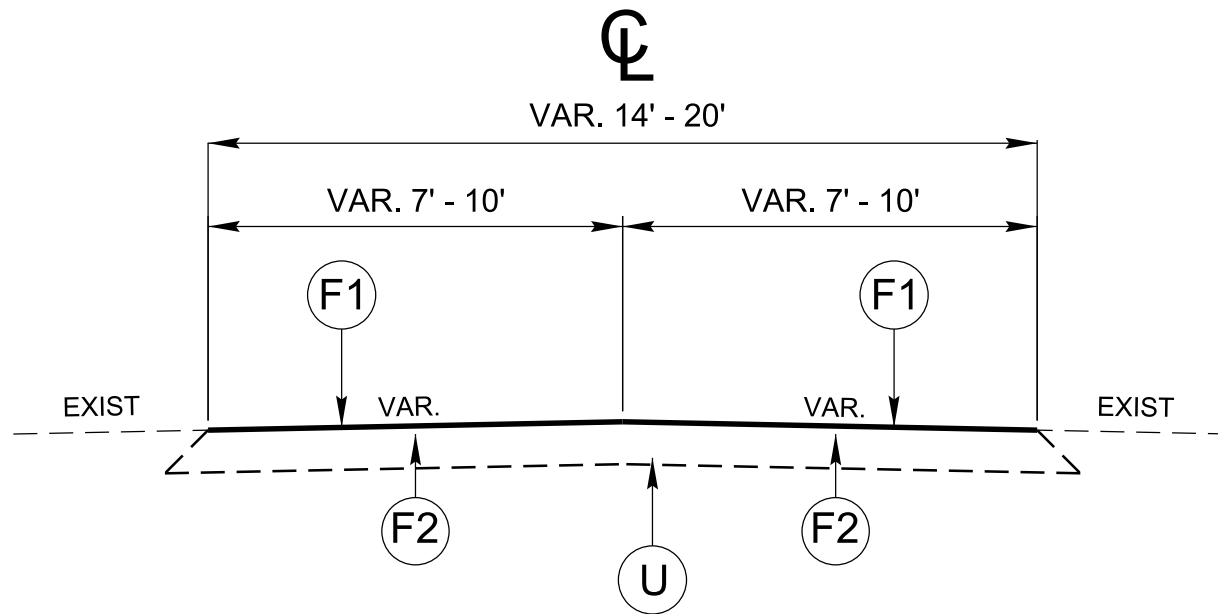

TYPICAL SECTION NO. 2
MAPS # 22-28, 35-39, 41-43, & 45-51

PAVEMENT SCHEDULE	
F1	ASPHALT SURFACE TREATMENT, FOG SEAL
F2	ASPHALT SURFACE TREATMENT, TRIPLE SEAL WITH NO.78M STONE
F3	ASPHALT SURFACE TREATMENT, MAT COAT WITH NO.67M STONE
U	EXISTING PAVEMENT

NOTE: TYPICALS ARE NOT TO SCALE

DIVISION 11 DISTRICT 3 COUNTIES ASPHALT SURFACE TREATMENT 2024 RESURFACING			
REVISIONS	INIT.	DATE	
N.C. DEPARTMENT of TRANSPORTATION DIVISION of HIGHWAYS DIVISION ELEVEN			SCALE: N/A DATE: 09/18/2023 PREPARED BY: DLH REVIEWED BY: REVIEWED BY:

8/17/99

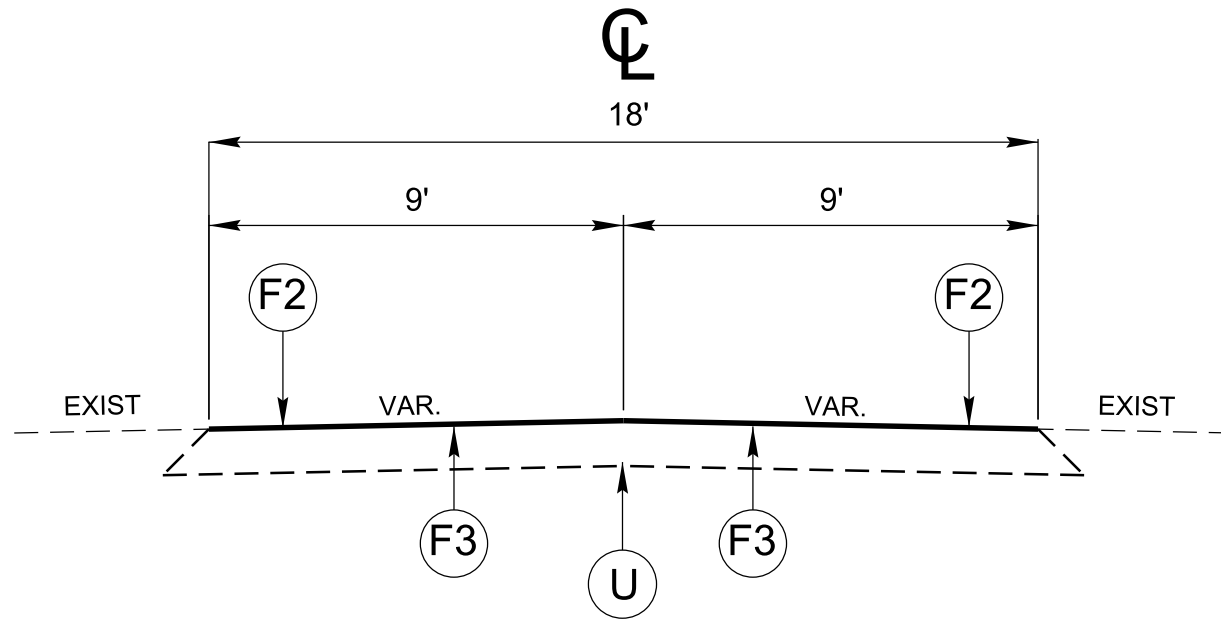

TYPICAL SECTION NO. 3
MAP # 17

PAVEMENT SCHEDULE	
F1	ASPHALT SURFACE TREATMENT, FOG SEAL
F2	ASPHALT SURFACE TREATMENT, TRIPLE SEAL WITH NO.78M STONE
F3	ASPHALT SURFACE TREATMENT, MAT COAT WITH NO.67M STONE
U	EXISTING PAVEMENT

NOTE: TYPICALS ARE NOT TO SCALE

DIVISION 11 DISTRICT 3 COUNTIES ASPHALT SURFACE TREATMENT 2024 RESURFACING			
REVISIONS	INIT.	DATE	
N.C. DEPARTMENT of TRANSPORTATION DIVISION of HIGHWAYS DIVISION ELEVEN			SCALE: N/A DATE: 09/18/2023 PREPARED BY: DLH REVIEWED BY: REVIEWED BY:

ASHE COUNTY

TYPE OF WORK: AST - SECONDARY ROUTES
MAPS # 1 THRU #11

2024

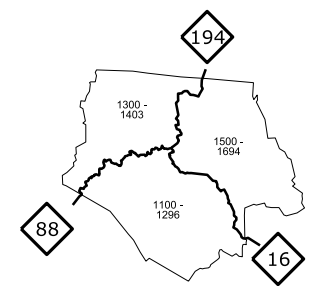
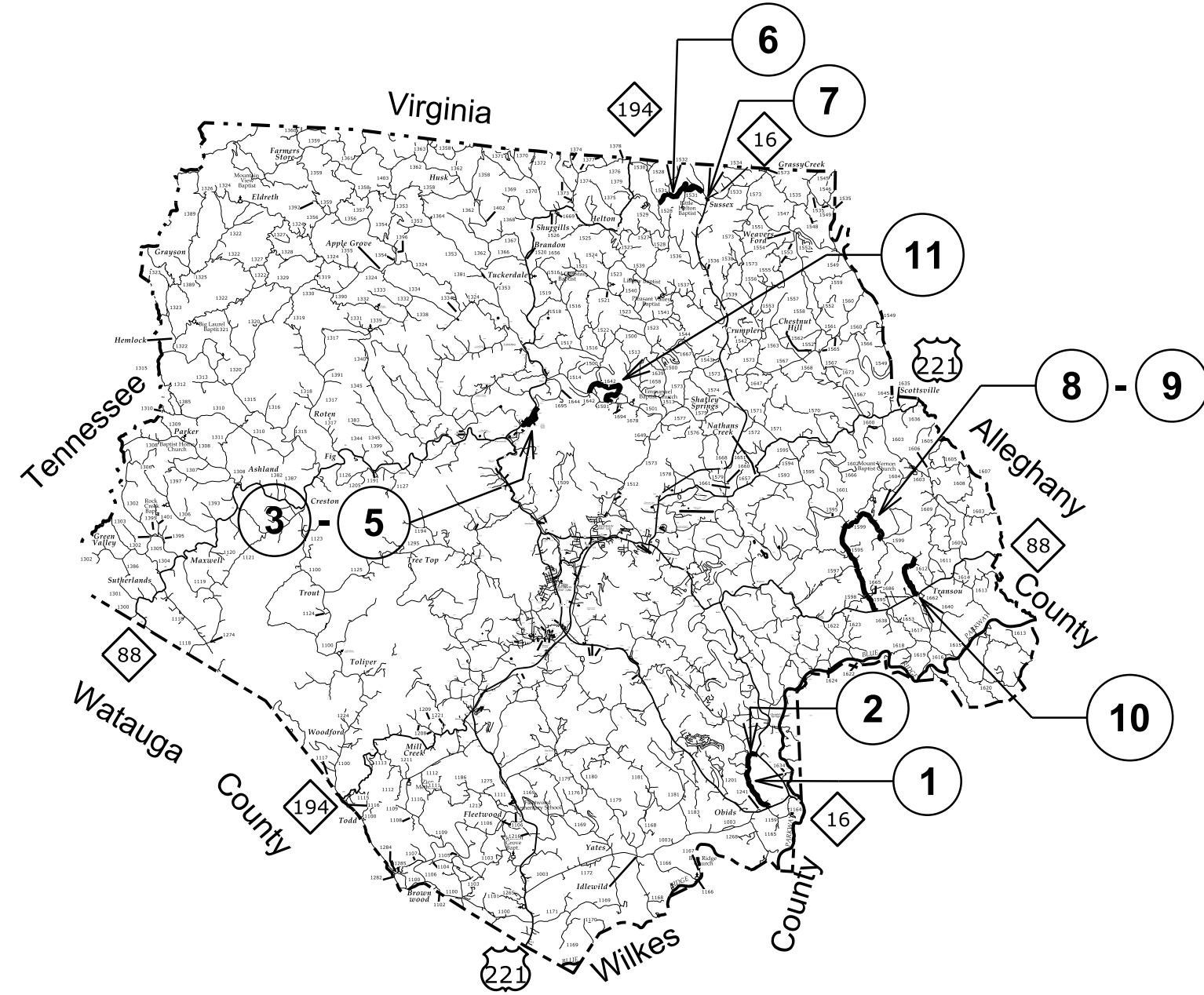
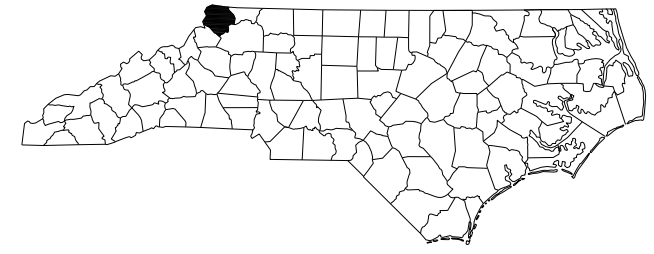

KEY TO COUNTY ROAD NUMBERS

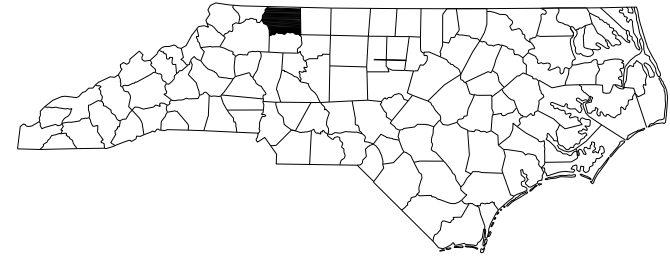

SURRY COUNTY

TYPE OF WORK: AST - SECONDARY ROUTES
MAP # 12

2024

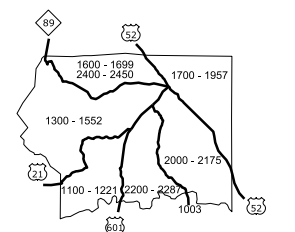
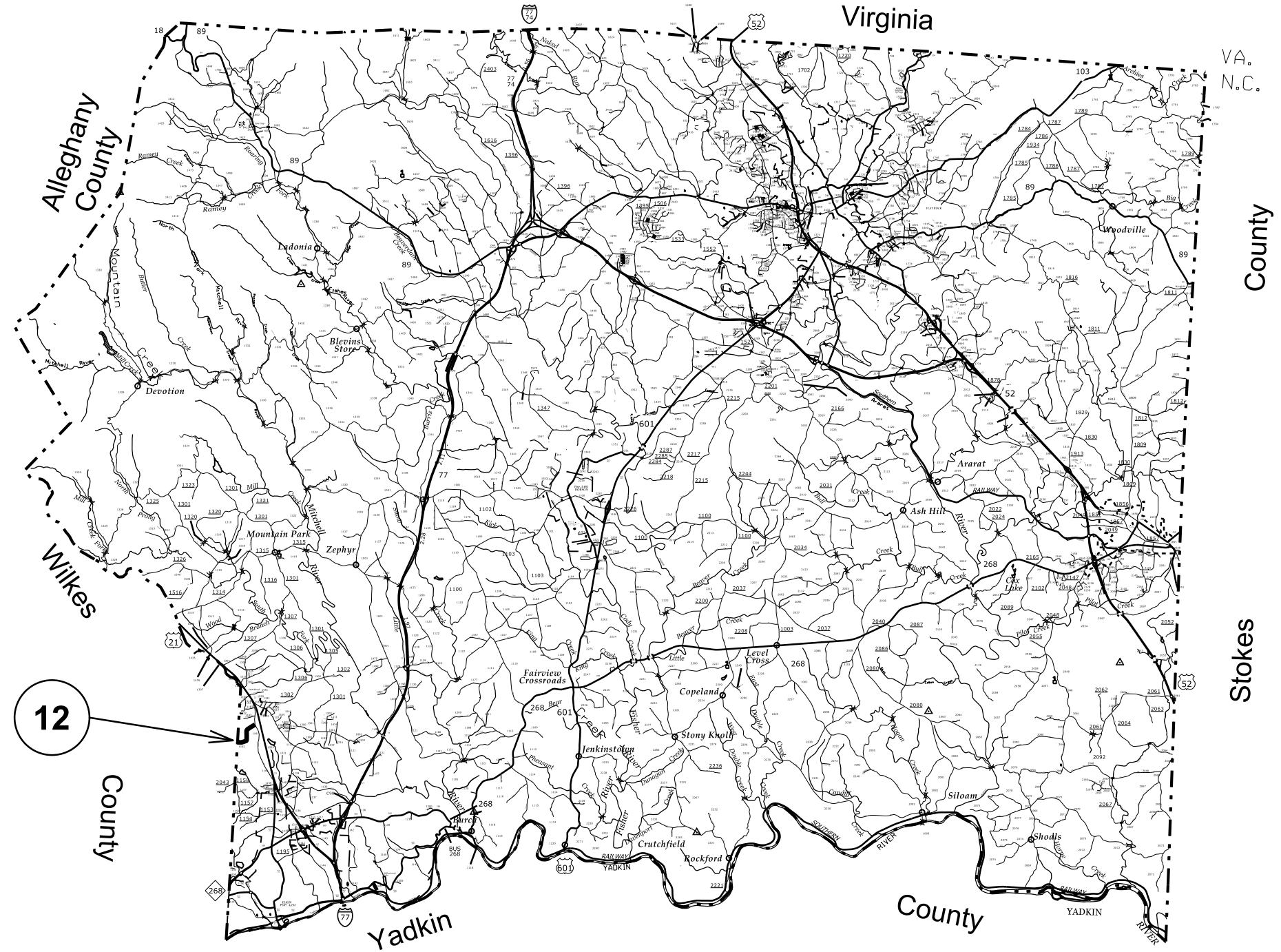

KEY TO COUNTY ROAD NUMBERS

WILKES COUNTY

TYPE OF WORK: AST - SECONDARY ROUTES
MAPS # 13 THRU # 40

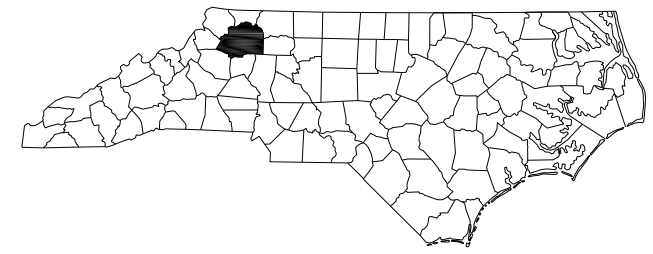

2024

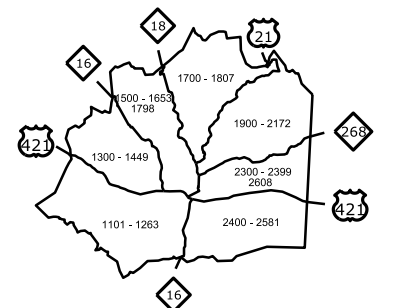
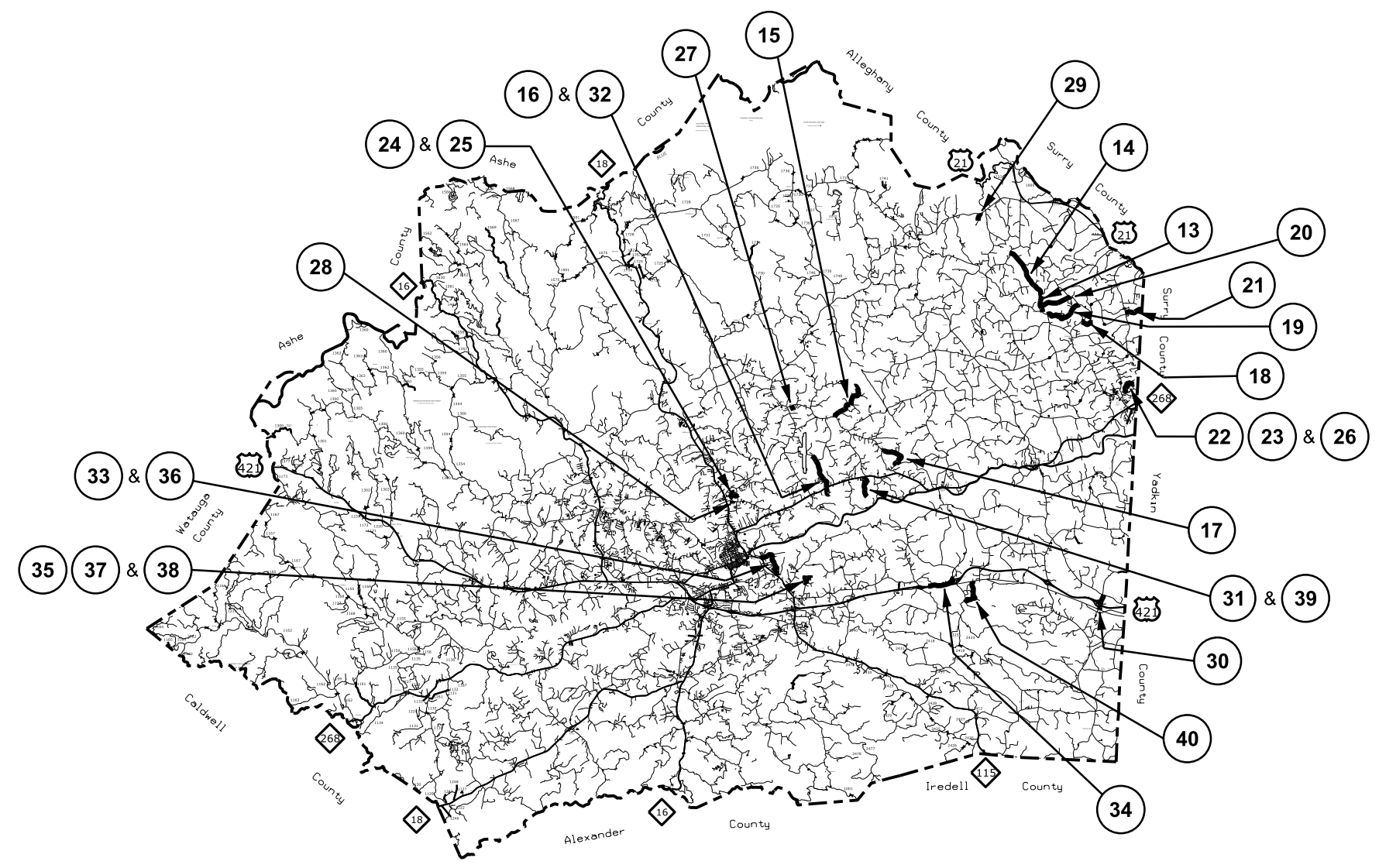

KEY TO COUNTY ROAD NUMBERS

WILKES COUNTY

TYPE OF WORK: AST - SECONDARY ROUTES
MAPS # 41 THRU # 51

2024

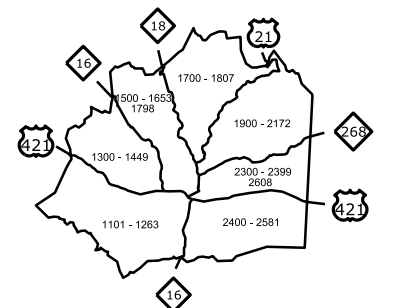
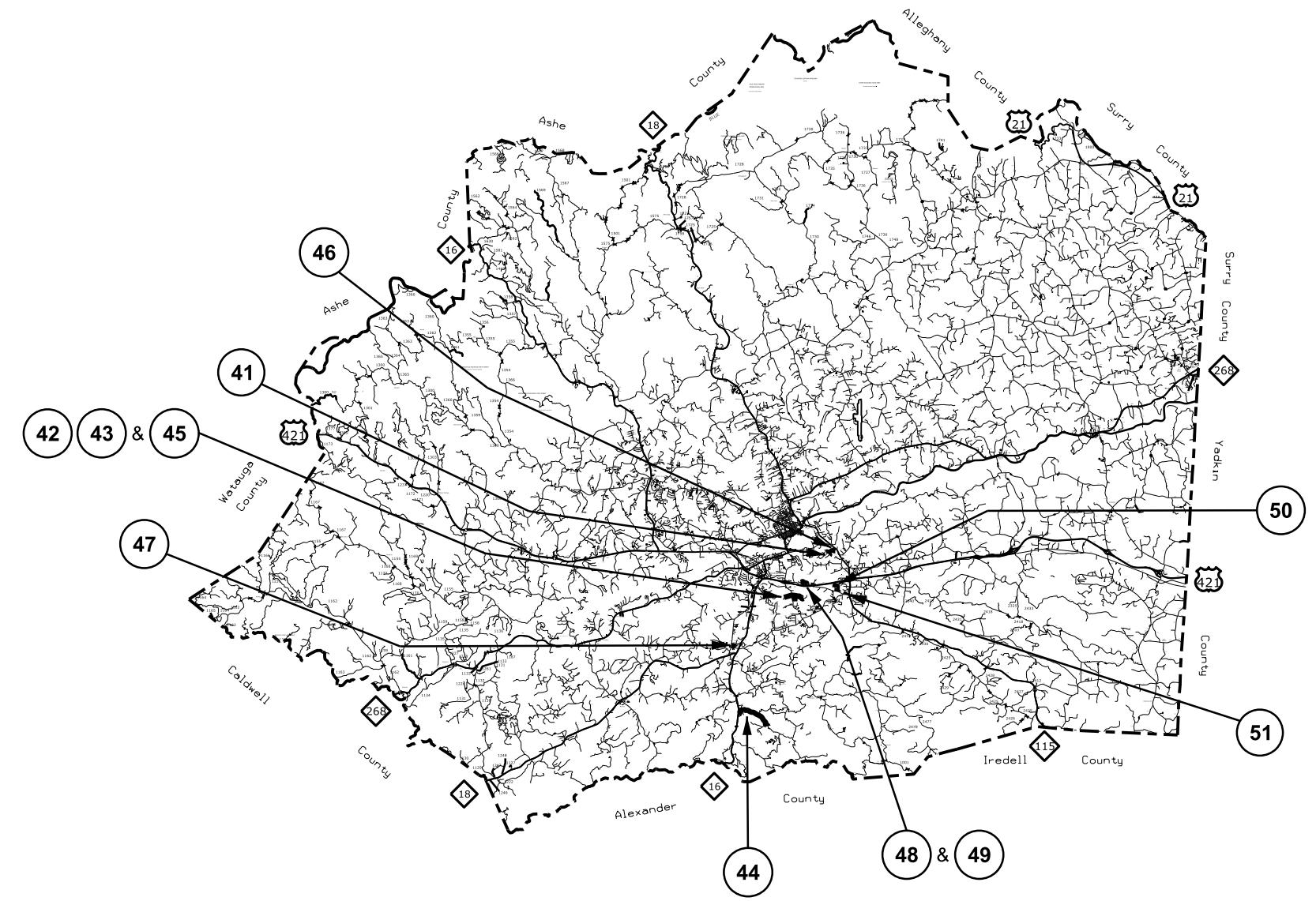

KEY TO COUNTY ROAD NUMBERS

														PROJECT NO.	SHEET NO.	TOTAL NO.				
														DK00373	7	9				
SUMMARY OF QUANTITIES																				
PROJECT NO	COUNTY	MAP NO	ROUTE	DESCRIPTION	TYP NO	LANES	LANE TYPE	FINAL SURFACE TESTING REQUIRED	WARM MIX ASPHALT REQUIRED	LENGTH	WIDTH	BEGIN MP	END MP	1775500000-E	1820000000-E	1836000000-E	1838000000-E	1838500000-N	2143000000-E	
														ASPHALT SURFACE TREATMENT, MAT COAT, #67 STONE	ASPHALT SURFACE TREATMENT, FOG SEAL	ASPHALT SURFACE TREATMENT, TRIPLE SEAL	EMULSION FOR ASPHALT SURFACE TREATMENT	VACUUM TRUCK	BLOTTING SAND	
										MI	FT				SY	SY	SY	GAL	WK	TON
2024CPT.11.23.20052	Ashe	1	SR-1159 / BARE RD	FROM SR 1162 TO NC 163	1	2	2WU	NO	NO	1.87	18	5.3	7.17							
2024CPT.11.23.20052	Ashe	2	SR-1162 / RENO RD	FROM SR 1159 TO NC 16	1	2	2WU	NO	NO	0.21	18	0	0.21							
				FROM BEGIN PAVEMENT/FANNIE COVE EXT (NS) TO EOM																
2024CPT.11.23.20052	Ashe	3	SR-1502 / JOE BADGER RD	FROM SR 1528 TO END PAVEMENT	1	2	2WU	NO	NO	0.67	16	0.36	1.03							
2024CPT.11.23.20052	Ashe	4	SR-1503 / LOW WATER BRIDGE RD	FROM SR 1504 TO SR 1502	1	2	2WU	NO	NO	0.11	16	0	0.11							
2024CPT.11.23.20052	Ashe	5	SR-1504 / RIVER DR	FROM NC 194 TO NC 194	1	2	2WU	NO	NO	0.35	16	0	0.35							
2024CPT.11.23.20052	Ashe	6	SR-1531 / SUSSEX RD	FROM SR 1528 TO END PAVEMENT	1	2	2WU	NO	NO	2.1	18	0	2.1							
2024CPT.11.23.20052	Ashe	7	SR-1531 / SUSSEX RD	FROM BEGIN PAVEMENT TO NC 16	1	2	2WU	NO	NO	0.08	18	2.32	2.4							
2024CPT.11.23.20052	Ashe	8	SR-1595 / LITTLE PEAK CREEK RD	FROM SR 1599 TO NC 88	1	2	2WU	NO	NO	2.8	20	3.47	6.27							
2024CPT.11.23.20052	Ashe	9	SR-1599 / BIG PEAK CREEK RD	FROM SR 1595 TO END PAVEMENT	1	2	2WU	NO	NO	1.7	20	0	1.7							
2024CPT.11.23.20052	Ashe	10	SR-1599 / BIG PEAK CREEK RD	FROM BEGIN PVMNT TO NC 88	1	2	2WU	NO	NO	1.46	18	2.95	4.41							
2024CPT.11.23.20052	Ashe	11	SR-1642 / PARKER ELLER RD	FROM SR 1501 TO SR 1501	1	2	2WU	NO	NO	1.95	18	0	1.95							
	TOTAL FOR PROJ NO. 2024CPT.11.23.20052									13.3						158,842	83,369	1	100	
2024CPT.11.23.20972	Surry	12	SR-1162 / KLONDIKE EXT RD	FROM WILKES CO LINE TO SR SR 1161	1	2	2WU	NO	NO	0.73	18	0	0.73							
2024CPT.11.23.20972	Wilkes	13	SR-1913 / MINING RIDGE CH RD	FROM SR 1916 TO SR 1752	1	2	2WU	NO	NO	0.68	18	3.82	4.5							
2024CPT.11.23.20972	Wilkes	14	SR-1916 / GRASSY FORK RD	FROM SR 1913 TO SR 1917	1	2	2WU	NO	NO	2.1	18	0	2.1							
2024CPT.11.23.20972	Wilkes	15	SR-1959 / LITTLE MTN CH RD	FROM SR 1957 TO EOM	1	2	2WU	NO	NO	1.8	19	0	1.8							
2024CPT.11.23.20972	Wilkes	16	SR-1984 / JOHNSON RD	FROM NC 268 TO EOM	1	2	2WU	NO	NO	1.48	16	0	1.48							
2024CPT.11.23.20972	Wilkes	17	SR-1992 / BRINEGAR HILL RD	FROM SR 1993 TO SR 1989	3	2	2WU	NO	NO	1.26	18	0	1.26	14,636						
2024CPT.11.23.20972	Wilkes	18	SR-2031 / ROXIE CLARK RD	FROM SR 2026 TO EOM	1	2	2WU	NO	NO	0.5	16	0	0.5							
2024CPT.11.23.20972	Wilkes	19	SR-2032 / BYRDS CURVE RD	SR 1752 TO SR 2026	1	2	2WU	NO	NO	1.6	18	0	1.6							
2024CPT.11.23.20972	Wilkes	20	SR-2033 / LAYELL RD	FROM SR 1913 TO SR 2026	1	2	2WU	NO	NO	1.26	18	0	1.26							
2024CPT.11.23.20972	Wilkes	21	SR-2041 / KLONDIKE RD EXT	FROM SURRY CO LINE TO SR 2037	1	2	2WU	NO	NO	0.68	18	0	0.68							
2024CPT.11.23.20972	Wilkes	22	SR-2053 / BLUE RIDGE AVE	FROM SR 2052 TO EOM	2	2	2WU	NO	NO	0.6	16	0	0.6							
2024CPT.11.23.20972	Wilkes	23	SR-2054 / BLUE RIDGE AVE	FROM SR 2053 TO EOM	2	2	2WU	NO	NO	0.2	14	0	0.2							
2024CPT.11.23.20972	Wilkes	24	SR-2074 / HILLTOP ACRES ST	FROM SR 1971 TO EOM	2	2	2WU	NO	NO	0.4	20	0	0.4							
2024CPT.11.23.20972	Wilkes	25	SR-2077 / OTIS BROWN DR	FROM SR 2074 TO EOM	2	2	2WU	NO	NO	0.31	16	0	0.31							
2024CPT.11.23.20972	Wilkes	26	SR-2088 / SADBERRY RD	FROM SR 2053 TO EOM	2	2	2WU	NO	NO	0.11	18	0	0.11							
2024CPT.11.23.20972	Wilkes	27	SR-2098 / NORTHVIEW DR	FROM SR 1957 TO CULDESAC	2	2	2WU	NO	NO	0.19	20	0	0.19							
2024CPT.11.23.20972	Wilkes	28	SR-2130 / OLIVER GANT RD	FROM SR 1971 TO EOM	2	2	2WU	NO	NO	0.12	16	0	0.12							
2024CPT.11.23.20972	Wilkes	29	SR-2146 / MTN VALLEY DR	FROM SR 1002 TO EOM	1	2	2WU	NO	NO	0.5	16	0	0.5							
2024CPT.11.23.20972	Wilkes	30	SR-2314 / DENNYVILLE RD	FROM SR 2576 TO SR 2303	1	2	M2	NO	NO	0.59	28	0	0.59							
2024CPT.11.23.20972	Wilkes	31	SR-2330 / RIDDLE RD	FROM NC 268 TO EOM	1	2	2WU	NO	NO	0.8	20	0	0.8							
2024CPT.11.23.20972	Wilkes	32	SR-2332 / KNOTVILLE RD	FROM NC 268 TO EOM	1	2	2WU	NO	NO	0.3	20	0	0.3							
2024CPT.11.23.20972	Wilkes	33	SR-2335 / ARMORY RD	FROM NC 115 TO NC 115	1	2	2WU	NO	NO	1.37	19	0	1.37							
2024CPT.11.23.20972	Wilkes	34	SR-2345 / MCGAMP RD	FROM SR 2325 TO EOM	1	2	2WU	NO	NO	1.09	20	0	1.09							
2024CPT.11.23.20972	Wilkes	35	SR-2362 / WINDING TRAILS DR	FROM SR 2338 TO SR 2373	2	2	2WU	NO	NO	0.22	20	0	0.22							
2024CPT.11.23.20972	Wilkes	36	SR-2370 / EASTWOOD DR	FROM SR 2345 TO CULDESAC	2	2	2WU	NO	NO	0.2	20	0	0.2							
2024CPT.11.23.20972	Wilkes	37	SR-2372 / BUTTERNUT RD	FROM SR 2373 TO CULDESAC	2	2	2WU	NO	NO	0.09	20	0	0.09							
2024CPT.11.23.20972	Wilkes	38	SR-2373 / EAST/WEST CROOKED BOW RD	FROM CULDESAC TO CULDESAC	2	2	2WU	NO	NO	0.35	20	0	0.35							
2024CPT.11.23.20972	Wilkes	39	SR-2389 / KEMP RD	FROM SR 2330 TO EOM	2	2	2WU	NO	NO	0.24	16	0	0.24							
2024CPT.11.23.20972	Wilkes	40	SR-2438 / JARVIS MTN RD	FROM SR 2576 TO SR 2325	1	2	2WU	NO	NO	1.16	18	0	1.16							
2024CPT.11.23.20972	Wilkes	41	SR-2449 / ANDERSON ST	FROM SR 2448 TO EOM	2	2	2WU	NO	NO	0.2	16	0	0.2							
2024CPT.11.23.20972	Wilkes	42	SR-2463 / SLEEPY AVENUE WEST RD	FROM CULDESAC TO SR 1001	2	2	2WU	NO	NO	0.29	18	0	0.29							
2024CPT.11.23.20972	Wilkes	43	SR-2463 / SLEEPY HOLLOW EAST RD	FROM SR 1001 TO EOM	2	2	2WU	NO	NO	0.49	18	0.3	0.79							
2024CPT.11.23.20972	Wilkes	44	SR-2488 / LOWE CREEK RD	FROM NC 16 TO EOP	1	2	2WU	NO	NO	1.52	18	0	1.52							
2024CPT.11.23.20972	Wilkes	45	SR-2496 / OAKWOODS LN	FROM SR 1001 TO EOM	2	2	2WU	NO	NO	0.2	16	0	0.2							
2024CPT.11.23.20972	Wilkes	46	SR-2501 / BOUCHELLE RD	FROM SR 2448 TO EOM	2	2	2WU	NO	NO	0.2	16	0	0.2							
2024CPT.11.23.20972	Wilkes	47	SR-2529 / NORWAY DR	FROM SR 1194 TO EOM	2	2	2WU	NO	NO	0.16	18	0	0.16							
2024CPT.11.23.20972	Wilkes	48	SR-2532 / EDGEWOOD RIDGE RD	FROM SR 2461 TO SR 2533	2	2	2WU	NO	NO	0.07	18	0	0.07							
2024CPT.11.23.20972	Wilkes	49	SR-2533 / EDGEWOOD RIDGE RD	FROM SR 2532 TO EOM	2	2	2WU	NO	NO	0.28	18	0	0.28							
2024CPT.11.23.20972	Wilkes	50	SR-2561 / PINE BROOK PL	FROM SR 2461 TO CULDESAC	2	2	2WU	NO	NO	0.36	20	0	0.36							
2024CPT.11.23.20972	Wilkes	51	SR-2570 / CLIFFORD LN	FROM SR 2462 TO CULDESAC	2	2	2WU	NO	NO	0.1	18	0	0.1							
	TOTAL FOR PROJ NO. 2024CPT.11.23.20972									24.07				14,636	61,726	291,013	197,924	1	100	
GRAND TOTAL										37.37				14,636	61,725.7	449,855	281,293	2	200	

PROJECT NO.	SHEET NO.	TOTAL NO.
DK00373	8	9

THERMOPLASTIC AND PAINT QUANTITIES

PROJECT NO	COUNTY	MAP NO	ROUTE	DESCRIPTION	TYP NO	LANES	LANE TYPE	LENGTH	WIDTH	BEGIN MP	END MP	4413000000-E	4457000000-N	4810000000-E	4820000000-E	4835000000-E	4845000000-N	
												WORK ZONE ADVANCE/GENERAL WARNING SIGNING	TEMPORARY TRAFFIC CONTROL	4" WHITE PAINT	4" YELLOW PAINT	8" YELLOW PAINT	24" WHITE PAINT	PAINT LT ARROW
												SF	LS	LF	LF	LF	LF	EA
2024CPT.11.23.20052	Ashe	1	SR-1159 / BARE RD	FROM SR 1162 TO NC 163	1	2	2WU	1.87	18	5.3	7.17	243		40,242	40,242			
2024CPT.11.23.20052	Ashe	2	SR-1162 / RENO RD	FROM SR 1159 TO NC 16	1	2	2WU	0.21	18	0	0.21	27		4,519	4,519			
2024CPT.11.23.20052	Ashe	3	SR-1502 / JOE BADGER RD	FROM BEGIN PAVEMENT/FANNIE COVE EXT (NS) TO EOM	1	2	2WU	0.67	16	0.36	1.03	87						
2024CPT.11.23.20052	Ashe	4	SR-1503 / LOW WATER BRIDGE RD	FROM SR 1504 TO SR 1502	1	2	2WU	0.11	16	0	0.11	14						
2024CPT.11.23.20052	Ashe	5	SR-1504 / RIVER DR	FROM NC 194 TO NC 194	1	2	2WU	0.35	16	0	0.35	46						
2024CPT.11.23.20052	Ashe	6	SR-1531 / SUSSEX RD	FROM SR 1528 TO END PAVEMENT	1	2	2WU	2.1	18	0	2.1	273		45,192	45,192			
2024CPT.11.23.20052	Ashe	7	SR-1531 / SUSSEX RD	FROM BEGIN PAVEMENT TO NC 16	1	2	2WU	0.08	18	2.32	2.4	10		1,722	1,722			
2024CPT.11.23.20052	Ashe	8	SR-1595 / LITTLE PEAK CREEK RD	FROM SR 1599 TO NC 88	1	2	2WU	2.8	20	3.47	6.27	364		60,256	60,256			
2024CPT.11.23.20052	Ashe	9	SR-1599 / BIG PEAK CREEK RD	FROM SR 1595 TO END PAVEMENT	1	2	2WU	1.7	20	0	1.7	221		36,584	36,584			
2024CPT.11.23.20052	Ashe	10	SR-1599 / BIG PEAK CREEK RD	FROM BEGIN PVMNT TO NC 88	1	2	2WU	1.46	18	2.95	4.41	190		31,419	31,419			
2024CPT.11.23.20052	Ashe	11	SR-1642 / PARKER ELLER RD	FROM SR 1501 TO SR 1501	1	2	2WU	1.95	18	0	1.95	254		41,964	41,964			
TOTAL FOR PROJ NO. 2024CPT.11.23.20052								13.3				1,729	0.336	261,898	261,898			
												523,796						
2024CPT.11.23.20972	Surry	12	SR-1162 / KLONDIKE EXT RD	FROM WILKES CO LINE TO SR SR 1161	1	2	2WU	0.73	18	0	0.73	95		15,710	15,710			
2024CPT.11.23.20972	Wilkes	13	SR-1913 / MINING RIDGE CH RD	FROM SR 1916 TO SR 1752	1	2	2WU	0.68	18	3.82	4.5	88		14,634	14,634			
2024CPT.11.23.20972	Wilkes	14	SR-1916 / GRASSY FORK RD	FROM SR 1913 TO SR 1917	1	2	2WU	2.1	18	0	2.1	273		45,192	45,192			
2024CPT.11.23.20972	Wilkes	15	SR-1959 / LITTLE MTN CH RD	FROM SR 1957 TO EOM	1	2	2WU	1.8	19	0	1.8	234		38,736	38,736			
2024CPT.11.23.20972	Wilkes	16	SR-1984 / JOHNSON RD	FROM NC 268 TO EOM	1	2	2WU	1.48	16	0	1.48	192		31,850	31,850			
2024CPT.11.23.20972	Wilkes	17	SR-1992 / BRINEGAR HILL RD	FROM SR 1993 TO SR 1989	3	2	2WU	1.26	18	0	1.26	164		27,115	27,115			
2024CPT.11.23.20972	Wilkes	18	SR-2031 / ROXIE CLARK RD	FROM SR 2026 TO EOM	1	2	2WU	0.5	16	0	0.5	65						
2024CPT.11.23.20972	Wilkes	19	SR-2032 / BYRDS CURVE RD	SR 1752 TO SR 2026	1	2	2WU	1.6	18	0	1.6	208		34,432	34,432			
2024CPT.11.23.20972	Wilkes	20	SR-2033 / LAYELL RD	FROM SR 1913 TO SR 2026	1	2	2WU	1.26	18	0	1.26	164		27,115	27,115			
2024CPT.11.23.20972	Wilkes	21	SR-2041 / KLONDIKE RD EXT	FROM SURRY CO LINE TO SR 2037	1	2	2WU	0.68	18	0	0.68	88		14,634	14,634			
2024CPT.11.23.20972	Wilkes	22	SR-2053 / BLUE RIDGE AVE	FROM SR 2052 TO EOM	2	2	2WU	0.6	16	0	0.6	78						
2024CPT.11.23.20972	Wilkes	23	SR-2054 / BLUE RIDGE AVE	FROM SR 2053 TO EOM	2	2	2WU	0.2	14	0	0.2	26						
2024CPT.11.23.20972	Wilkes	24	SR-2074 / HILLTOP ACRES ST	FROM SR 1971 TO EOM	2	2	2WU	0.4	20	0	0.4	52						
2024CPT.11.23.20972	Wilkes	25	SR-2077 / OTIS BROWN DR	FROM SR 2074 TO EOM	2	2	2WU	0.31	16	0	0.31	40						
2024CPT.11.23.20972	Wilkes	26	SR-2088 / SADBERRY RD	FROM SR 2053 TO EOM	2	2	2WU	0.11	18	0	0.11	14						
2024CPT.11.23.20972	Wilkes	27	SR-2098 / NORTHVIEW DR	FROM SR 1957 TO CULDESAC	2	2	2WU	0.19	20	0	0.19	25						
2024CPT.11.23.20972	Wilkes	28	SR-2130 / OLIVER GANT RD	FROM SR 1971 TO EOM	2	2	2WU	0.12	16	0	0.12	16						
2024CPT.11.23.20972	Wilkes	29	SR-2146 / MTN VALLEY DR	FROM SR 1002 TO EOM	1	2	2WU	0.5	16	0	0.5	65						
2024CPT.11.23.20972	Wilkes	30	SR-2314 / DENNVILLE RD	FROM SR 2576 TO SR 2303	1	2	M2	0.59	28	0	0.59	77		12,697	25,394	1,000	100	10
2024CPT.11.23.20972	Wilkes	31	SR-2330 / RIDDLE RD	FROM NC 268 TO EOM	1	2	2WU	0.8	20	0	0.8	104						
2024CPT.11.23.20972	Wilkes	32	SR-2332 / KNOTVILLE RD	FROM NC 268 TO EOM	1	2	2WU	0.3	20	0	0.3	39						
2024CPT.11.23.20972	Wilkes	33	SR-2335 / ARMORY RD	FROM NC 115 TO NC 115	1	2	2WU	1.37	19	0	1.37	178		29,482	29,482			
2024CPT.11.23.20972	Wilkes	34	SR-2345 / MCGAMP RD	FROM SR 2325 TO EOM	1	2	2WU	1.09	20	0	1.09	142		23,457	23,457			
2024CPT.11.23.20972	Wilkes	35	SR-2362 / WINDING TRAILS DR	FROM SR 2338 TO SR 2373	2	2	2WU	0.22	20	0	0.22	29						
2024CPT.11.23.20972	Wilkes	36	SR-2370 / EASTWOOD DR	FROM SR 2345 TO CULDESAC	2	2	2WU	0.2	20	0	0.2	26						
2024CPT.11.23.20972	Wilkes	37	SR-2372 / BUTTERNUT RD	FROM SR 2373 TO CULDESAC	2	2	2WU	0.09	20	0	0.09	12						
2024CPT.11.23.20972	Wilkes	38	SR-2373 / EAST/WEST CROOKED BOW RD	FROM CULDESAC TO CULDESAC	2	2	2WU	0.35	20	0	0.35	46						
2024CPT.11.23.20972	Wilkes	39	SR-2389 / KEMP RD	FROM SR 2330 TO EOM	2	2	2WU	0.24	16	0	0.24	31						
2024CPT.11.23.20972	Wilkes	40	SR-2438 / JARVIS MTN RD	FROM SR 2576 TO SR 2325	1	2	2WU	1.16	18	0	1.16	151		24,963	24,963			
2024CPT.11.23.20972	Wilkes	41	SR-2449 / ANDERSON ST	FROM SR 2448 TO EOM	2	2	2WU	0.2	16	0	0.2	26						
2024CPT.11.23.20972	Wilkes	42	SR-2463 / SLEEPY AVENUE WEST RD	FROM CULDESAC TO SR 1001	2	2	2WU	0.29	18	0	0.29	38						
2024CPT.11.23.20972	Wilkes	43	SR-2463 / SLEEPY HOLLOW EAST RD	FROM SR 1001 TO EOM	2	2	2WU	0.49	18	0.3	0.79	64						
2024CPT.11.23.20972	Wilkes	44	SR-2488 / LOWE CREEK RD	FROM NC 16 TO EOP	1	2	2WU	1.52	18	0	1.52	198		32,710	32,710			
2024CPT.11.23.20972	Wilkes	45	SR-2496 / OAKWOODS LN	FROM SR 1001 TO EOM	2	2	2WU	0.2	16	0	0.2	26						
2024CPT.11.23.20972	Wilkes	46	SR-2501 / BOUCHELLE RD	FROM SR 2448 TO EOM	2	2	2WU	0.2	16	0	0.2	26						
2024CPT.11.23.20972	Wilkes	47	SR-2529 / NORWAY DR	FROM SR 1194 TO EOM	2	2	2WU	0.16	18	0	0.16	21						
2024CPT.11.23.20972	Wilkes	48	SR-2532 / EDGEWOOD RIDGE RD	FROM SR 2461 TO SR 2533	2	2	2WU	0.07	18	0	0.07	9						
2024CPT.11.23.20972	Wilkes	49	SR-2533 / EDGEWOOD RIDGE RD	FROM SR 2532 TO EOM	2	2	2WU	0.28	18	0	0.28	36						
2024CPT.11.23.20972	Wilkes	50	SR-2561 / PINE BROOK PL	FROM SR 2461 TO CULDESAC	2	2	2WU	0.36	20	0	0.36	47						
2024CPT.11.23.20972	Wilkes	51	SR-2570 / CLIFFORD LN	FROM SR 2462 TO CULDESAC	2	2	2WU	0.1	18	0	0.1	13						
TOTAL FOR PROJ NO. 2024CPT.11.23.20972								24.8				3,226		372,727	385,424	1,000	100	10
												758,151						
GRAND TOTAL								38.1				4,955	0	634,625	647,322	1,000	100	10
												1,281,947						

SIGNING FOR ASPHALT SURFACE TREATMENT

LEGEND

- ◁ PORTABLE SIGN
- ┆ STATIONARY SIGN
- DIRECTION OF TRAFFIC FLOW

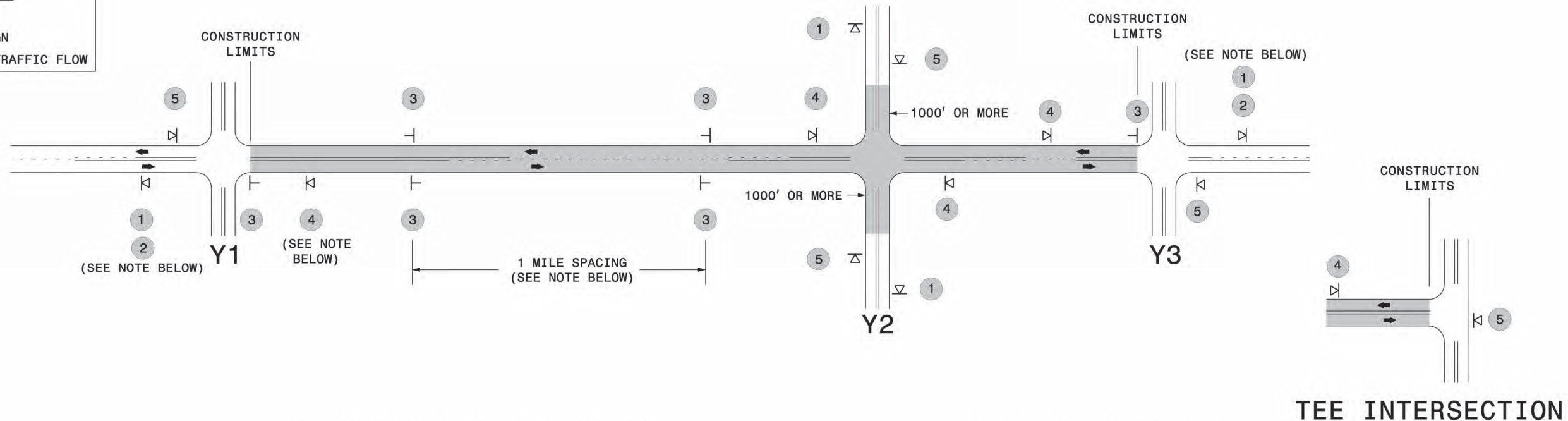

MAINLINE (-L-) SIGNING

-Y- LINE SIGNING

SIGNING NOTES AND PLACEMENT PER DIRECTION	1	 	<ul style="list-style-type: none"> - PLACE 1000' PRIOR TO BEGINNING OF CONSTRUCTION LIMITS. ONLY USED ON -Y- LINES IF RESURFACING LIMITS EXTEND 1000' ALONG -Y- LINE. - SIGN #2 ONLY USED WHEN RESURFACING LIMITS ARE 2 OR MORE MILES IN LENGTH. ROUND UP TO THE NEAREST WHOLE NUMBER. DO NOT USE FRACTIONAL OR DECIMAL NUMBERS. 	<p>STATIONARY SIGNING NOT REQUIRED FOR THE FOLLOWING -Y- LINE CONDITIONS:</p> <ol style="list-style-type: none"> 1) LESS THAN 1000' OF RESURFACING ALONG -Y- LINE 2) SUBDIVISION ROADS 3) DEAD END ROADS <p>WHEN PAVING/CONSTRUCTION ACTIVITIES PROCEED ACROSS AN UNSIGNED -Y- LINE, PORTABLE ADVANCE WARNING SIGNS SHALL BE USED ALONG THE -Y- LINE AS SHOWN BELOW. REMOVE UPON COMPLETION OF WORK.</p> <div style="display: flex; justify-content: space-around; align-items: center;"> <div style="text-align: center;"> <small>W20-1 48" X 48"</small> PLACED 500' IN ADVANCE OF FLAGGER. </div> <div style="text-align: center;"> <small>W20-7 A 48" X 48"</small> PLACED 250' IN ADVANCE OF FLAGGER. </div> </div>
	3	 	<ul style="list-style-type: none"> - ALTERNATE THE FOLLOWING TWO SIGNS: - STARTING WITH "LOOSE GRAVEL" (W8-7) FOLLOWED BY "UNMARKED PAVEMENT". - PLACE INITIALLY AT THE CONSTRUCTION LIMITS AND SPACED 1 MILE APART THEREAFTER. - AT TEE INTERSECTIONS INSTALL INITIALLY 0.5 MILE FROM INTERSECTION AND SPACE 1 MILE APART THEREAFTER. 	
	4		<ul style="list-style-type: none"> - THESE ARE FOR -Y- LINES THAT ARE "THROUGH" ROADWAYS. DEAD END AND SUBDIVISION ROADS ARE NOT "THROUGH" ROADWAYS. - INSTALL 500' +/- FROM EACH -Y- LINE APPROACH AS SHOWN ABOVE. - FOR MULTIPLE -Y- LINES THAT ARE SEPARATED BY 0.25 MILES OR LESS, TREAT AS A SINGLE UNIT AND INSTALL WITHIN 500' OF EACH APPROACH. - A MAXIMUM OF 2 SIGN SETS PER MILE. DO NOT INSTALL WHEN -Y- LINES ARE WITHIN 0.5 MILES FROM "END ROAD WORK" SIGN. 	
	5		<ul style="list-style-type: none"> - PLACE 500' FOLLOWING THE END OF CONSTRUCTION LIMITS OR AS SHOWN WHEN WORK ENDS AT A 3-WAY TEE INTERSECTION. 	
	<p>THE ABOVE SIGNS ARE ALL THAT ARE REQUIRED FOR A CONTRACTOR TO BEGIN A RESURFACING CONTRACT. ANY ADDITIONAL SIGNS REQUESTED BY NCDOT DIVISIONS SHALL BE INSTALLED WITHIN 7 BUSINESS DAYS OF THE START OF CONTRACT WORK.</p>			

MAPS LESS THAN 2 MILES

FOR AST RESURFACING MAPS WITH CONSTRUCTION LIMITS LESS THAN 2 MILES IN LENGTH, USE A STATIONARY "LOOSE GRAVEL" SIGN AT THE BEGINNING CONSTRUCTION LIMIT FOLLOWED BY AN "UNMARKED PAVEMENT" SIGN MIDWAY THROUGH AND AN "END ROAD WORK" SIGN AT THE END CONSTRUCTION LIMIT.

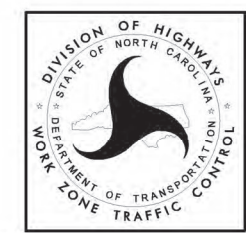

**ADVANCE WARNING SIGNS
FOR
2-LANE ROADWAY
ASPHALT SURFACE TREATMENT**

5/12/2017 S:\TMD\WZTC\Resurfacing\2L2W & AST Resurfacing Details\Resurfacing_AdvWarn_2Ln - AST.dgn User:kedals